

SOUTH RIBBLE BOROUGH COUNCIL

ANTI-SOCIAL BEHAVIOUR, CRIME AND POLICING ACT 2014

**THE DOGS ON LEADS IN THE BOROUGH OF SOUTH RIBBLE PUBLIC SPACES
PROTECTION ORDER 2024**

The South Ribble Borough Council (in this Order called "the Council") under Part 4, Section 59 of the Anti-Social Behaviour, Crime and Policing Act 2014 ("the Act"), being satisfied that the conditions set out in Section 59 have been met, hereby makes the following Order:

1. The Order comes into force on the 23/10 2024 and shall last for three years unless extended by the Council.
2. This Order applies to the land specified in the Schedule below ("the Restricted Area").
3. In this Order "an Authorised Person" means an employee of the Council who is authorised in writing by the Council for the purposes of giving directions under this Order.
4. In this Order "any road" includes any adjoining, adjacent or associated footpath, verge or pavement.

Offence

5. A person in charge of dog shall be guilty of an offence if at any time they cause or permit a dog to be on any part of the Restricted Area without the dog being held on a lead.
6. Nothing in this Order shall make it an offence for a person to cause or permit a dog to be on any part of the Restricted Area without the dog being held on a lead if:
 - a. the dog can be proved to be kept for driving or tending sheep or cattle in the course of a trade or business; or
 - b. to have been at the material time in use, under proper control for sporting purposes.
7. In this article "a lead" shall be taken to mean a chord of suitable length that is appropriately and securely attached to the dog for the purposes of allowing the person in control of the dog to hold or restrain that dog.

Penalty

8. By virtue of Section 67 of the Act it is an offence for a person without reasonable excuse to do anything that is prohibited by this Order.
9. A person who is guilty of an offence under this Order shall be liable on summary conviction to a fine not exceeding level 3 (currently £1,000) on the standard scale

Fixed Penalty

10. By virtue of Section 68 of the Act a constable or an Authorised Person may issue a fixed penalty notice not exceeding £100 to anyone he or she has reason to believe has committed an offence under section 67 of the Act in relation to this Order.

Appeals

11. Any challenge to this Order must be made at the High Court within six weeks of the Order being made, and must be by an individual who lives in, regularly works in or visits the Restricted Area.

Interested persons can challenge the validity of the Order on two grounds: that the Council did not have the power to make the Order or to include particular prohibitions or requirements; or that one of the requirements of the legislation has not been complied with.

When an application is made, the High Court can decide to suspend the operation of the Order pending the Court's decision, in part or in totality. The High Court has the ability to uphold the Order, quash it, or vary it.

SCHEDULE

Description of public places to which order applies

This Order applies to all public places within the administrative area in the Borough of South Ribble and which is:

- (i) Highways – this includes all carriageway and road, footway (aka pavement) footpath,bridleway, byway or cycle track and adjoining footpaths and verges.
- (ii) Footpaths, walkways and paths linked or associated with play areas owned by the Council.
- (iii) Land provided or used for public enjoyment, recreation and sporting or educational purposes during an organised activity on that land.
- (iv) Land, which is used as a market or fair or for the sale of goods at the time it is being used for that purpose.
- (v) Land used for the consumption of food or drink in connection with any trade, business or undertaking supplying food or drink at the time it is being used for that purpose.
- (vi) Land which is any forecourt, terrace, yard or walkway providing access to or adjoining any building to which the public resort or have access to.
- (vii) Land, which is any platform, forecourt, waiting area, walkway or shelter at any bus,or rail station, hackney carriage rank or designated hackney carriage waiting place.
- (viii) Land, which is used as memorial, burial ground, cemetery, garden or remembrance and adjoining footpaths and verges.
- (ix) Also;
 - Longton Brickcroft Nature Reserve
 - Access Land to Longton Marsh
 - Hurst Grange Coach House, Penwortham
 - Kingsfold Drive Teen Play Area, Penwortham
 - New Longton Ball Area, New Longton
 - Tardy Gate Play Area, Lostock Hall
 - Worden Park – The Formal Gardens, The Maze, The Walled Garden and the Arts & Craft Centre Courtyard
 - Worden Park - Fish Pond Boardwalk

(shown edged red for identification purposes on the plans attached hereto).

IN WITNESS whereof the Council have caused the Common Seal of the South Ribble Borough Council to be hereunto fixed this 23rd day of October 2024

EXECUTED AS A DEED by
SOUTH RIBBLE BOROUGH COUNCIL

by affixing its Common Seal
the day and year first written above

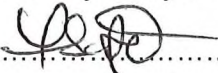

Authorised Signatory



56827

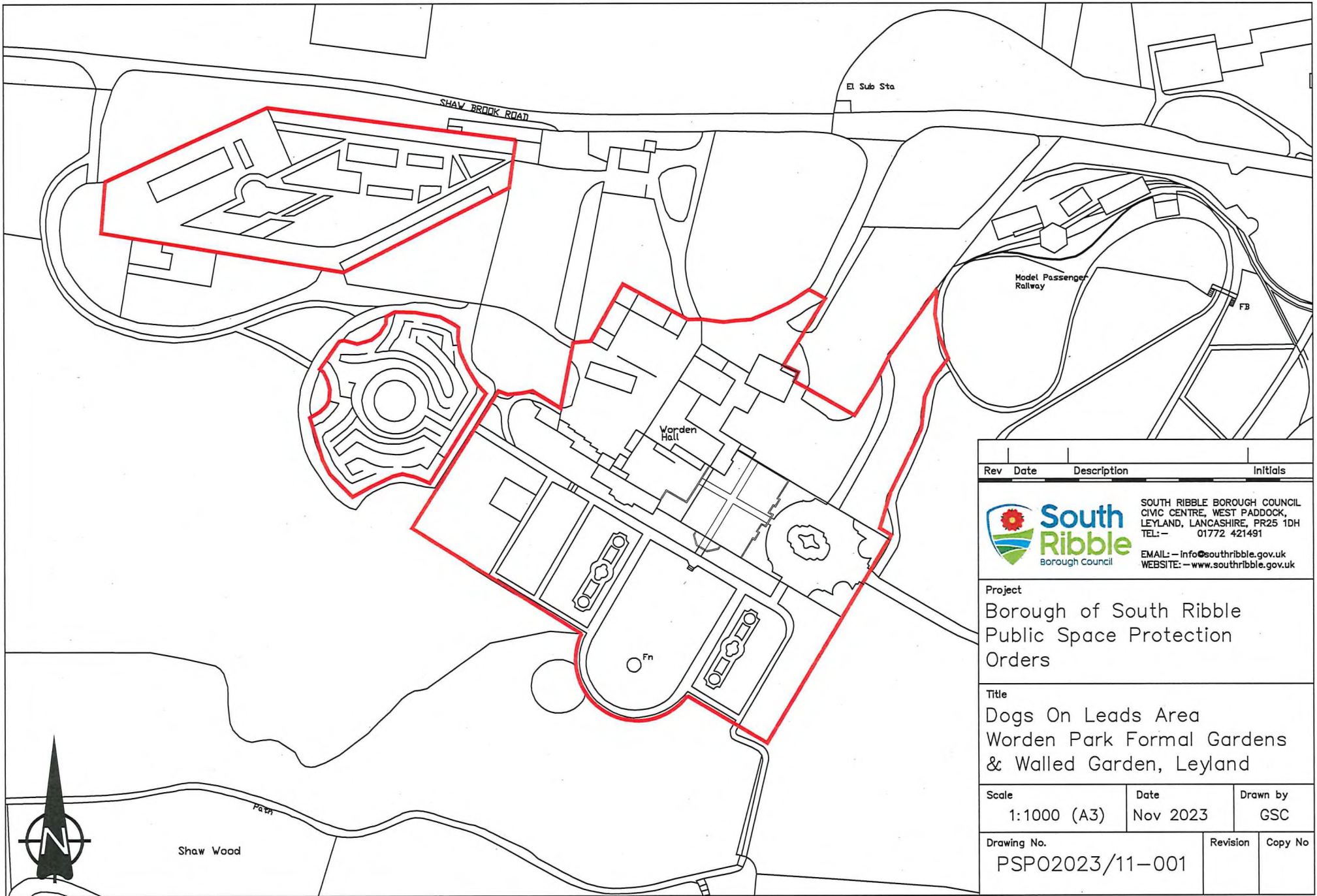

Rev	Date	Description	Initials
 <p>SOUTH RIBBLE BOROUGH COUNCIL CIVIC CENTRE, WEST PADDOCK, LEYLAND, LANCASHIRE, PR25 1DH TEL: - 01772 421491 EMAIL: - info@southribble.gov.uk WEBSITE: - www.southribble.gov.uk</p>			
<p>Project Borough of South Ribble Public Space Protection Orders</p>			
<p>Title Dogs On Leads Area Worden Park Formal Gardens & Walled Garden, Leyland</p>			
<p>Scale 1:1000 (A3)</p>		<p>Date Nov 2023</p>	<p>Drawn by GSC</p>
<p>Drawing No. PSP02023/11-001</p>			<p>Revision</p>
			<p>Copy No</p>

[Handwritten signature]

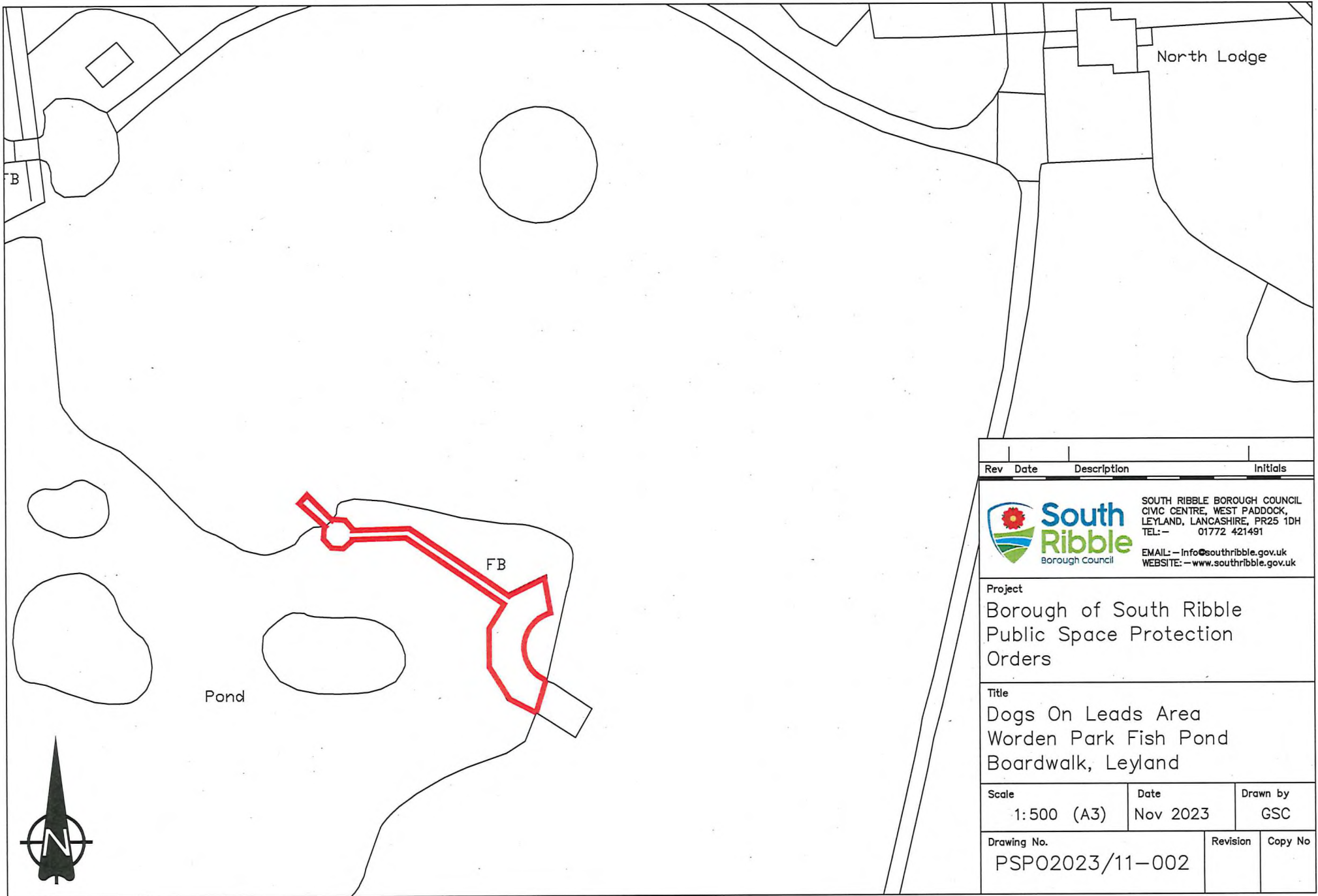

Rev	Date	Description	Initials
		SOUTH RIBBLE BOROUGH COUNCIL CIVIC CENTRE, WEST PADDOCK, LEYLAND, LANCASHIRE, PR25 1DH TEL: - 01772 421491 EMAIL: - info@southribble.gov.uk WEBSITE: - www.southribble.gov.uk	
Project Borough of South Ribble Public Space Protection Orders			
Title Dogs On Leads Area Worden Park Fish Pond Boardwalk, Leyland			
Scale 1:500 (A3)		Date Nov 2023	Drawn by GSC
Drawing No. PSP02023/11-002		Revision	Copy No

[Handwritten signature]

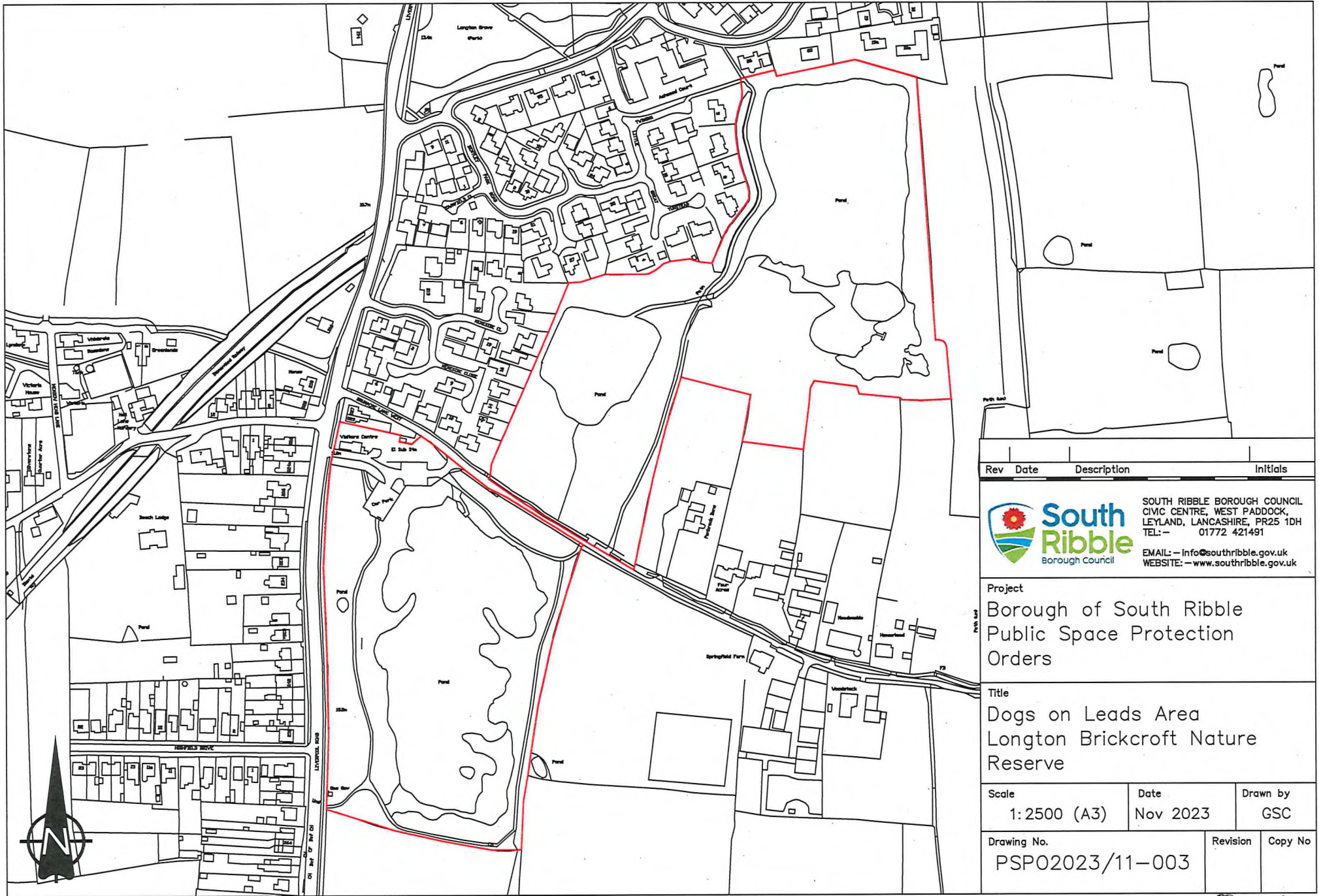

Rev	Date	Description	Initials
 <p>SOUTH RIBBLE BOROUGH COUNCIL CIVIC CENTRE, WEST PADDOCK, LEYLAND, LANCASHIRE, PR25 1DH TEL: - 01772 421491 EMAIL: - info@southribble.gov.uk WEBSITE: - www.southribble.gov.uk</p>			
<p>Project Borough of South Ribble Public Space Protection Orders</p>			
<p>Title Dogs on Leads Area Longton Brickcroft Nature Reserve</p>			
<p>Scale 1:2500 (A3)</p>		<p>Date Nov 2023</p>	<p>Drawn by GSC</p>
<p>Drawing No. PSP02023/11-003</p>			<p>Revision Copy No</p>

[Handwritten signature]

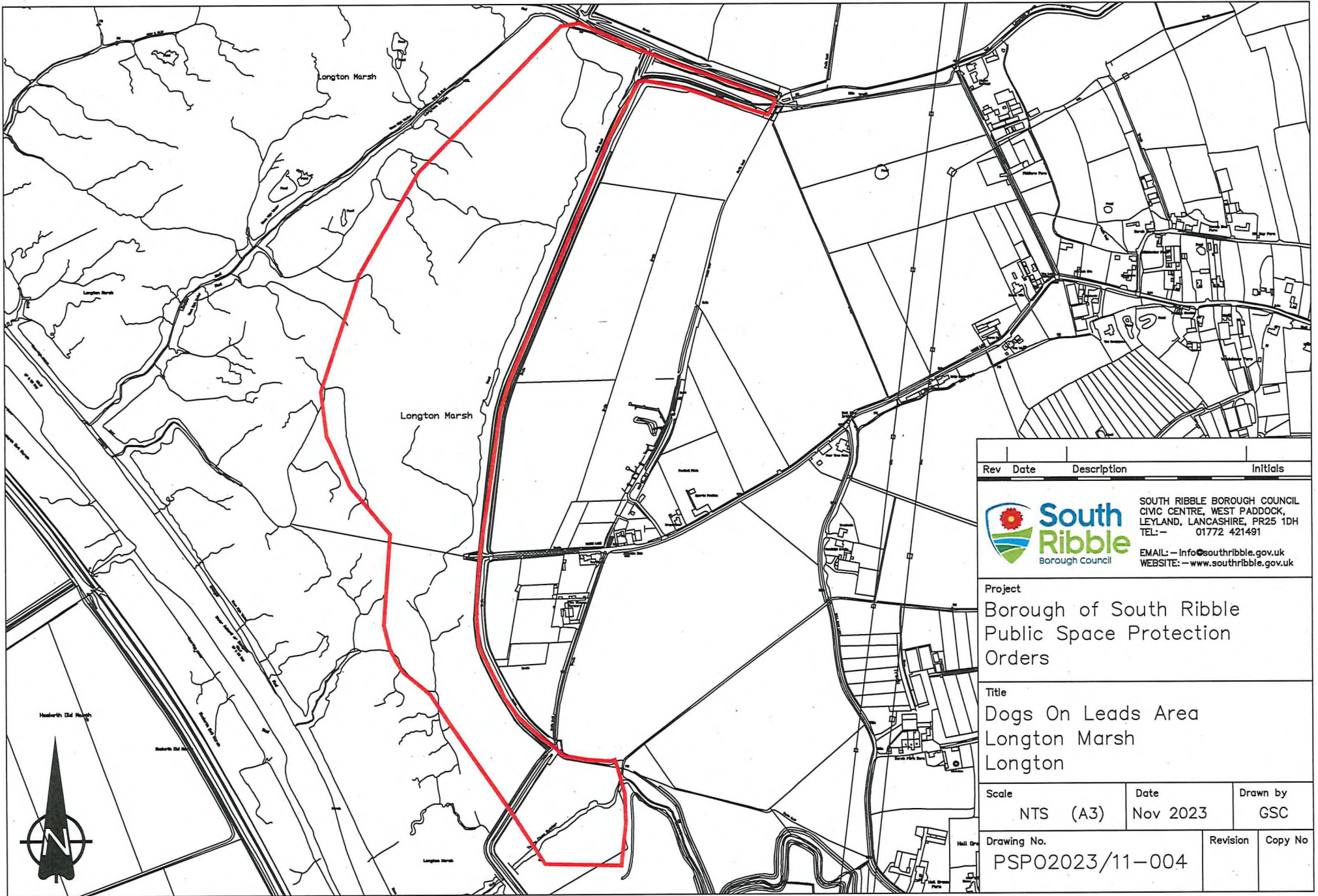

Rev	Date	Description	Initials
 <p>SOUTH RIBBLE BOROUGH COUNCIL CIVIC CENTRE, WEST PADDOCK, LEYLAND, LANCASHIRE, PR25 1DH TEL: - 01772 421491 EMAIL: - info@southribble.gov.uk WEBSITE: - www.southribble.gov.uk</p>			
<p>Project Borough of South Ribble Public Space Protection Orders</p>			
<p>Title Dogs On Leads Area Longton Marsh Longton</p>			
<p>Scale NTS (A3)</p>		<p>Date Nov 2023</p>	<p>Drawn by GSC</p>
<p>Drawing No. PSP02023/11-004</p>			<p>Revision Copy No</p>

[Handwritten signature]

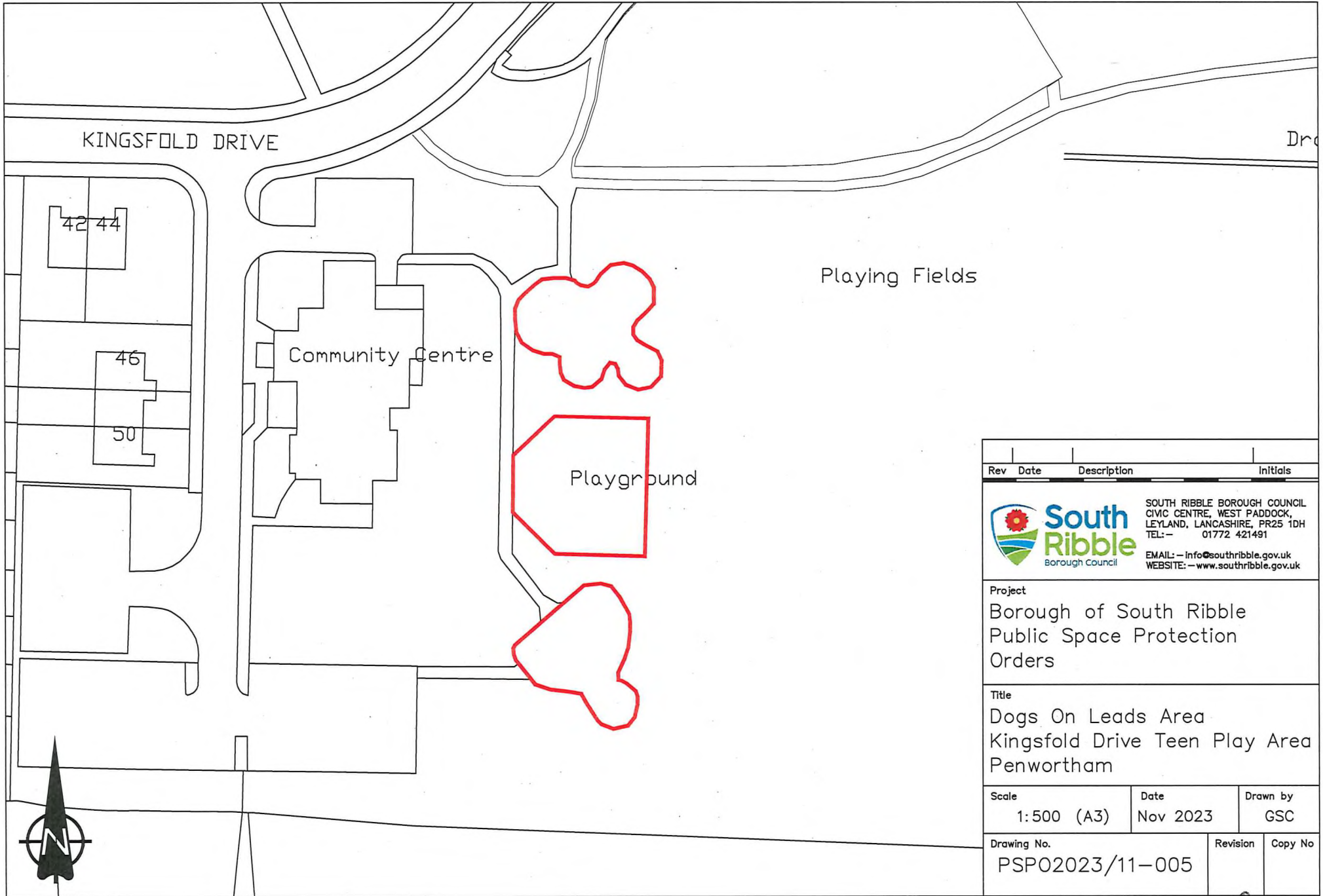

Rev	Date	Description	Initials
 <p>South Ribble Borough Council</p> <p>SOUTH RIBBLE BOROUGH COUNCIL CIVIC CENTRE, WEST PADDOCK, LEYLAND, LANCASHIRE, PR25 1DH TEL: - 01772 421491 EMAIL: - info@southribble.gov.uk WEBSITE: - www.southribble.gov.uk</p>			
<p>Project Borough of South Ribble Public Space Protection Orders</p>			
<p>Title Dogs On Leads Area Kingsfold Drive Teen Play Area Penwortham</p>			
<p>Scale 1:500 (A3)</p>		<p>Date Nov 2023</p>	<p>Drawn by GSC</p>
<p>Drawing No. PSP02023/11-005</p>			<p>Revision</p>
			<p>Copy No</p>

[Handwritten signature]

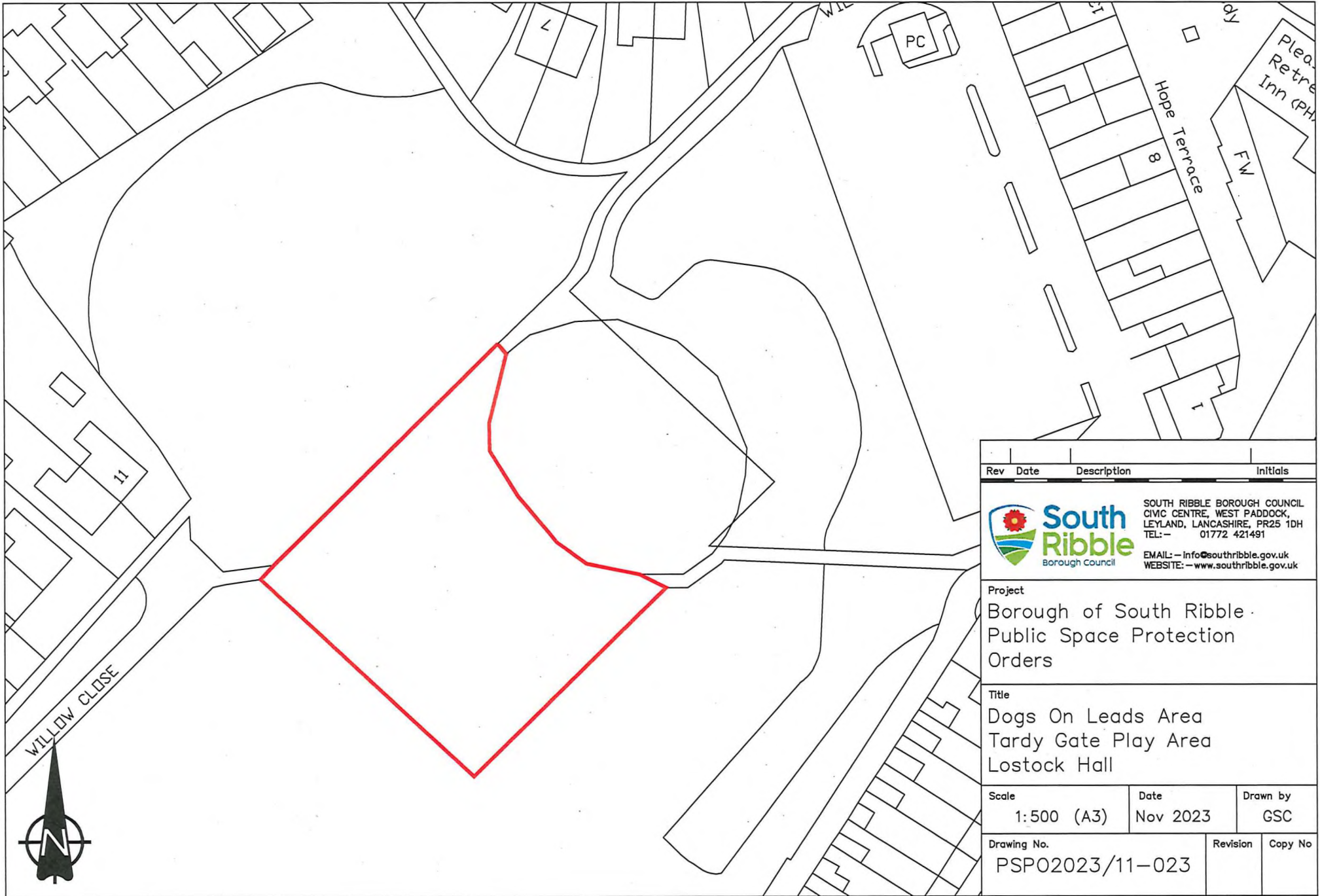

Rev	Date	Description	Initials
 <p>SOUTH RIBBLE BOROUGH COUNCIL CIVIC CENTRE, WEST PADDOCK, LEYLAND, LANCASHIRE, PR25 1DH TEL:- 01772 421491 EMAIL:- info@southribble.gov.uk WEBSITE:- www.southribble.gov.uk</p>			
Project Borough of South Ribble Public Space Protection Orders			
Title Dogs On Leads Area Tardy Gate Play Area Lostock Hall			
Scale 1:500 (A3)		Date Nov 2023	Drawn by GSC
Drawing No. PSP02023/11-023			Revision Copy No

Handwritten signature

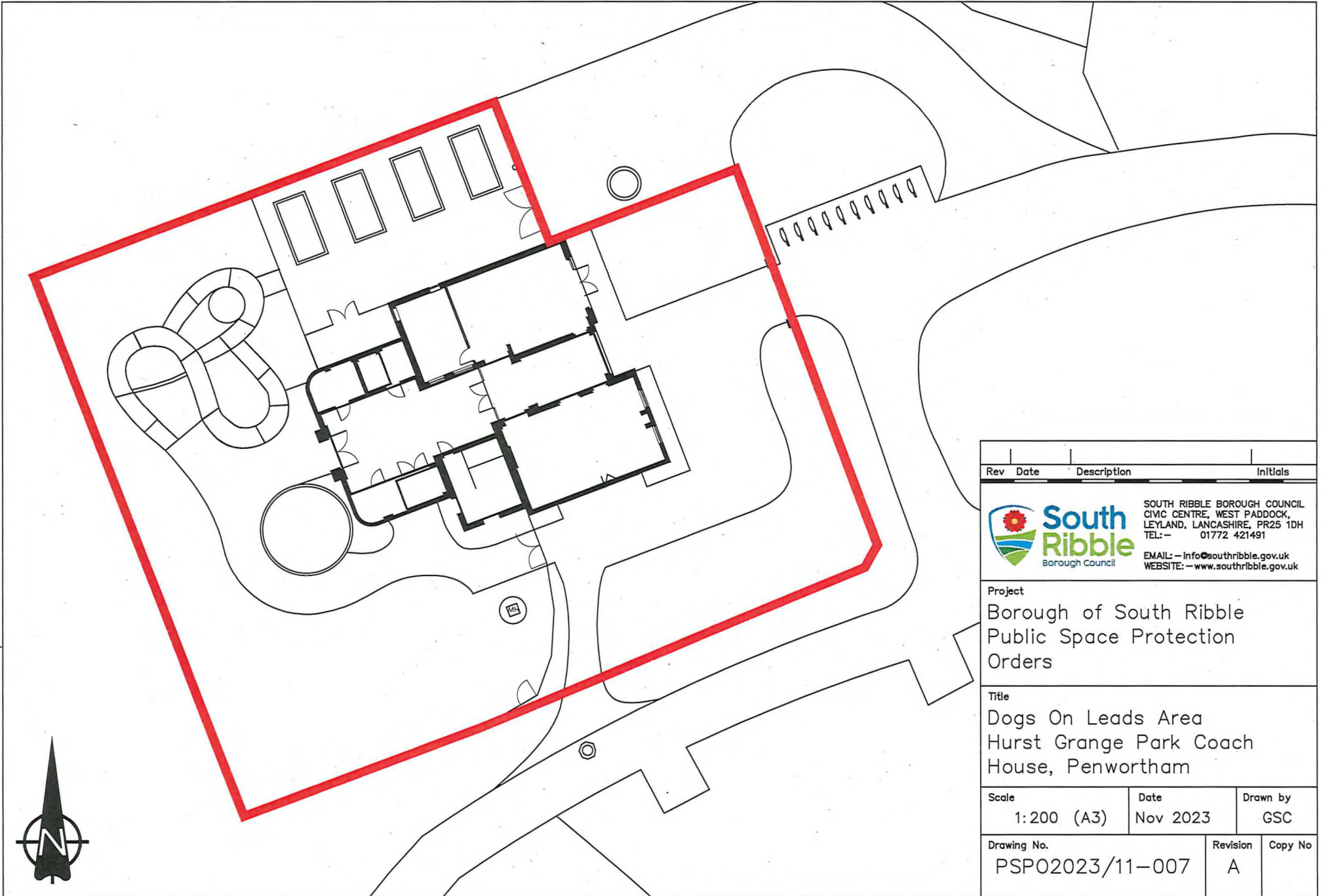

Rev	Date	Description	Initials
 <p>SOUTH RIBBLE BOROUGH COUNCIL CIVIC CENTRE, WEST PADDOCK, LEYLAND, LANCASHIRE, PR25 1DH TEL: - 01772 421491 EMAIL: - info@southribble.gov.uk WEBSITE: - www.southribble.gov.uk</p>			
<p>Project Borough of South Ribble Public Space Protection Orders</p>			
<p>Title Dogs On Leads Area Hurst Grange Park Coach House, Penwortham</p>			
<p>Scale 1:200 (A3)</p>		<p>Date Nov 2023</p>	<p>Drawn by GSC</p>
<p>Drawing No. PSP02023/11-007</p>		<p>Revision A</p>	<p>Copy No </p>

Handwritten signature

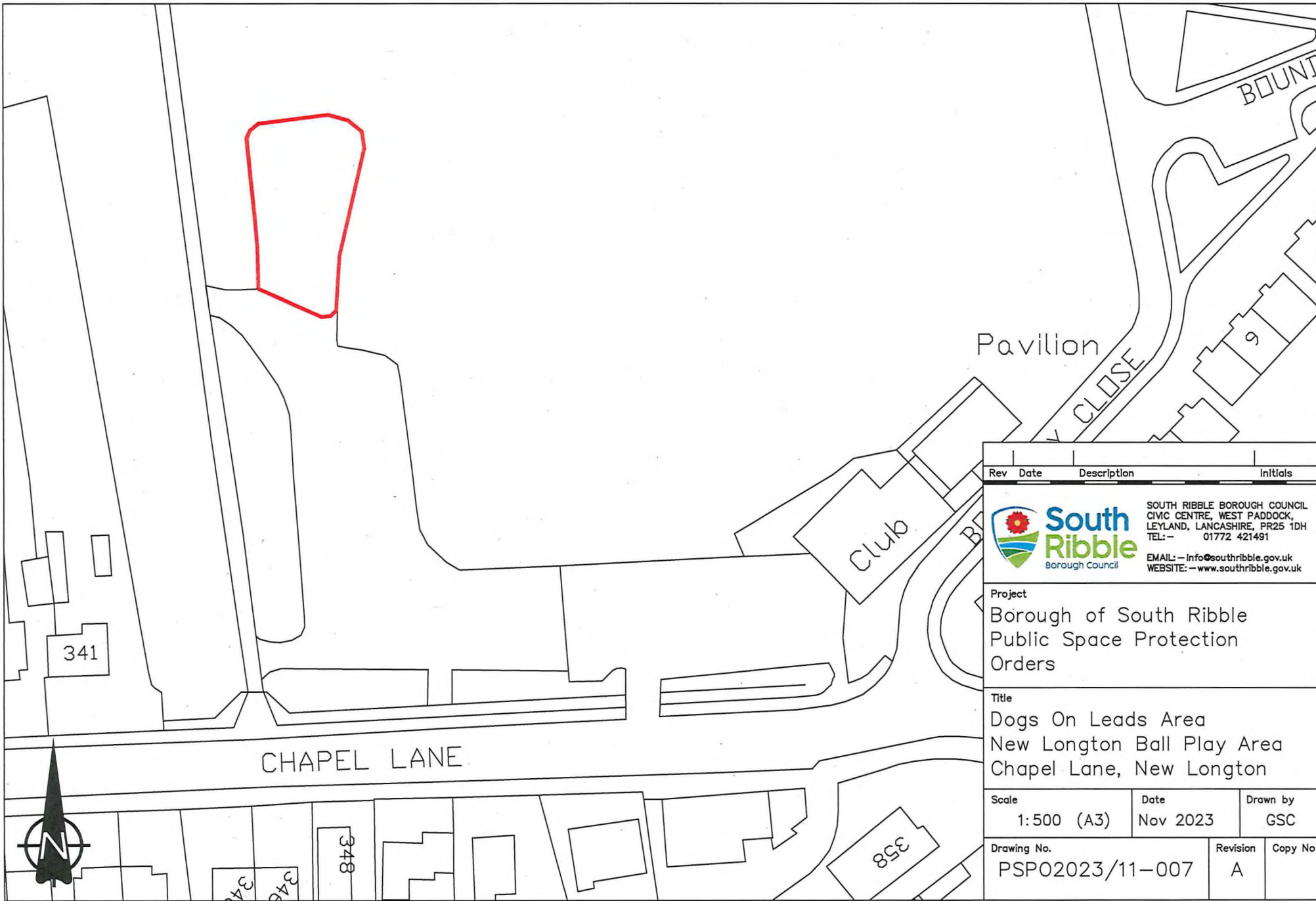

Rev	Date	Description	Initials
 <p>SOUTH RIBBLE BOROUGH COUNCIL CIVIC CENTRE, WEST PADDOCK, LEYLAND, LANCASHIRE, PR25 1DH TEL: - 01772 421491 EMAIL: - info@southribble.gov.uk WEBSITE: - www.southribble.gov.uk</p>			
<p>Project Borough of South Ribble Public Space Protection Orders</p>			
<p>Title Dogs On Leads Area New Longton Ball Play Area Chapel Lane, New Longton</p>			
<p>Scale 1:500 (A3)</p>		<p>Date Nov 2023</p>	<p>Drawn by GSC</p>
<p>Drawing No. PSP02023/11-007</p>			<p>Revision A</p>
			<p>Copy No</p>

[Handwritten signature]